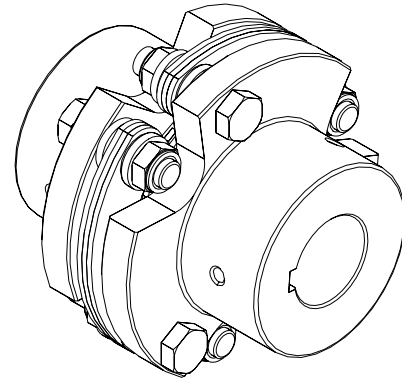

**Table of contents**

<u>Pg</u>	<u>Description</u>
1	Installation Procedure
2	Assembly Specifications
3	Hub installation Specifications
4	Parts List



**Installation Instructions for Composite Disc Couplings**

**Stainless Steel Single Flex Series 6Axx-SS**

1. Mount coupling hubs on the shafts. Be sure there are no burrs on the shafts or keys (if used).
2. Adjust hub separation to the dimension specified in the Table 1 and diagram 1. If possible, the shafts should not extend beyond the inside hub face. Tighten hubs to shafts (See Table 2 and Table 3 for proper tightening torque).
3. Align the shafts to within the limits for parallel and angular misalignment specified in Table 1. See diagrams 2 and 3 for recommended measurement and alignment methods.

For best alignment results, use a dial indicator. Always rotate the hub on which the indicator is mounted.

Coupling and shaft alignment should be checked periodically due to foundation settling, equipment shifting, etc. Alignment should be re-checked after the first several hours of operation.

4. Install the disc pack between the hubs. Three bolts connect the disc pack to each hub (6 bolts total). Insert the bolts thru the 3 holes of each hub and tighten the locknuts per the Table 1 tightening torque specifications. Tighten the locknuts of one hub, then those of the other hub to approximately  $\frac{1}{2}$  the stated torque value. Next repeat the process but tightening to the full torque value. It is also recommended to apply torque on the locknut, not the bolt. Re-check and tighten all fasteners after several hours of operation to ensure proper tightening.

**\*NOTE: Aligning the shafts as closely as possible at the time of initial installation will allow the coupling extra capacity for misalignments and loads which will occur during operation over the life of the connected equipment. Installing and operating the coupling at higher degrees of misalignment is possible (see catalog ratings), but will generally reduce the life of the flex disc pack.**

**\*NOTE: Rotating equipment is potentially dangerous and should be properly guarded. The user should follow all applicable safety codes and provide a suitable guard.**

# ////// ZERO-MAX

MOTION CONTROL PRODUCTS

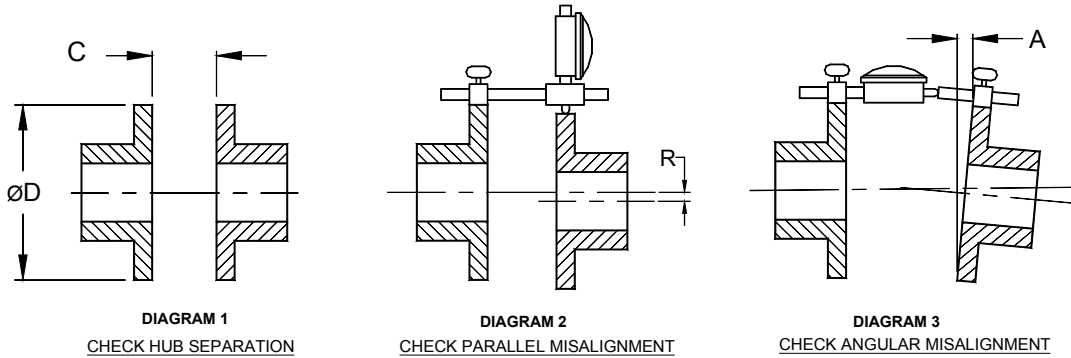

**Table 1**  
**Alignment and Assembly Specifications for Stainless Steel Single Flex Series 6Axx-ss**

Model	Recommended maximum installed misalignments						Tightening Torque (Dry values)		Unit Outside Diameter Ø D	
	C See Diagram 1		R See Diagram 2		A See Diagram 3				Inch	mm
	Inch	mm	Inch	mm	Inch	mm				
6A30-SS	0.460±0.017	11.68±0.43	0.003	0.08	0.026	0.66	90-95 in lb	10.5 Nm	3.00	76.2
6A37-SS	0.522±0.023	13.26±0.58	0.004	0.10	0.033	0.83	225-235 in lb	26 Nm	3.75	95.3
6A45-SS	0.582±0.030	14.78±0.76	0.005	0.13	0.039	1.00	36-38 ft lb	51 Nm	4.50	114.3
6A52-SS	0.646±0.037	16.41±0.94	0.006	0.15	0.046	1.20	36-38 ft lb	51 Nm	5.25	133.4

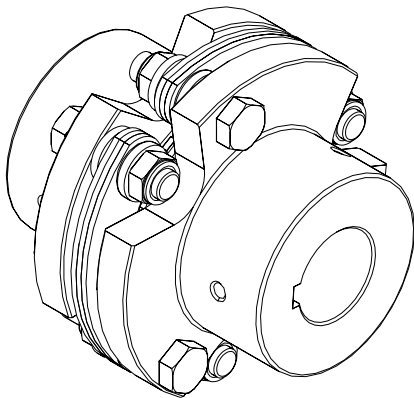

**Fig. 1**  
**Set Screw Style Hub**

**Table 2**  
**Stainless Steel Set Screw Torque Table**

Screw Size	Wrench Size	Torque (in lb)	Torque (Nm)
1/4-20unc	0.125	70	7.9
3/8-16unc	0.188	230	26
1/2-13unc	0.250	500	56
Metric			
M5 x 0.8	2.5mm	28	3.2
M6 x 1.0	3mm	51	5.8
M8 x 1.25	4mm	120	13.6
M10 x 1.50	5mm	230	26

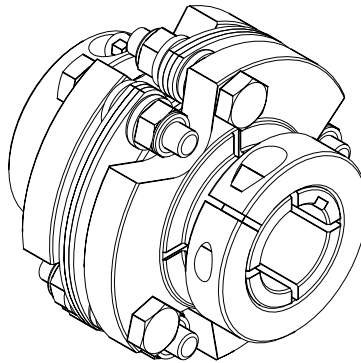

**Fig. 2**  
Clamp Style Hub

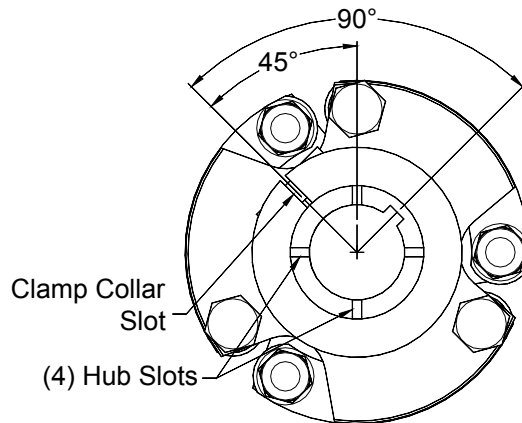

**Fig. 3**  
Clamp Slot Location

**Table 3**

Stainless Steel Clamp Collar Bolt Torque Table

Clamp bolt Size	Wrench Size	Torque (in lb)	Torque (Nm)
1/4-28unf	0.188	110	12.4
5/16-24unf	0.250	195	22
3/8-24unf	0.312	345	39
<b>Metric</b>			
M6 x 1.0	5mm	85	9.6
M8 x 1.25	6mm	195	22

**Clamp Hub Assembly**

Before tightening the clamp collar screw(s), orient the clamp collar slot (see Fig. 3) 90 degrees from the keyway centerline. If there is no keyway orient the clamp collar slot 45 degrees from one of the hub slots (see Fig. 3)

# ////// **ZERO-MAX**

MOTION CONTROL PRODUCTS

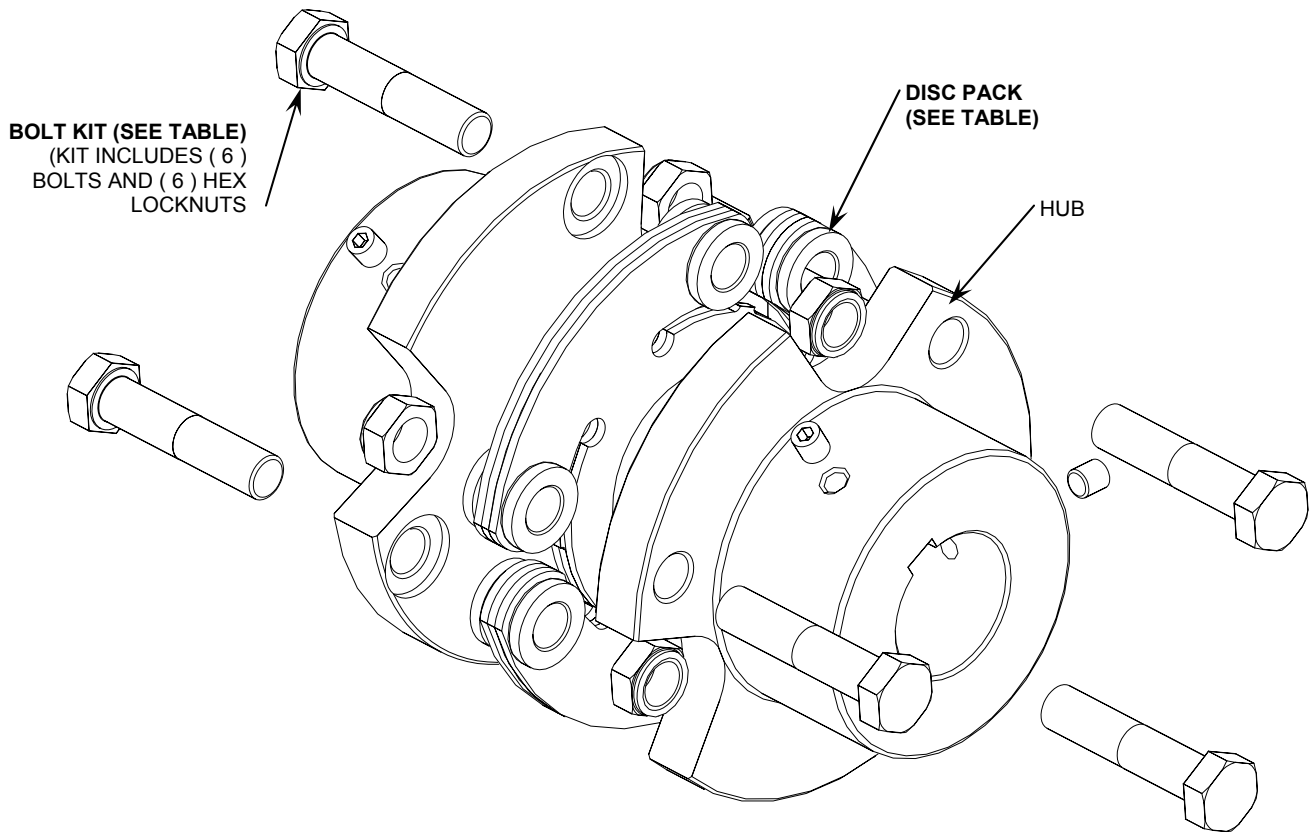

**Fig. 5**

**Table 4  
Replacement Parts**

Model	Hub OD (inch)	Disc Pack		Bolt Kit	
		Qty	Part No	Qty	Part No
6A30-SS	3.00	1	A030020	1	A030150
6A37-SS	3.75	1	A037001	1	A037150
6A45-SS	4.50	1	A045001	1	A045150
6A52-SS	5.25	1	A052001	1	A052150